

2-Piece Burj Bath Filler Mixer

Installation Guide

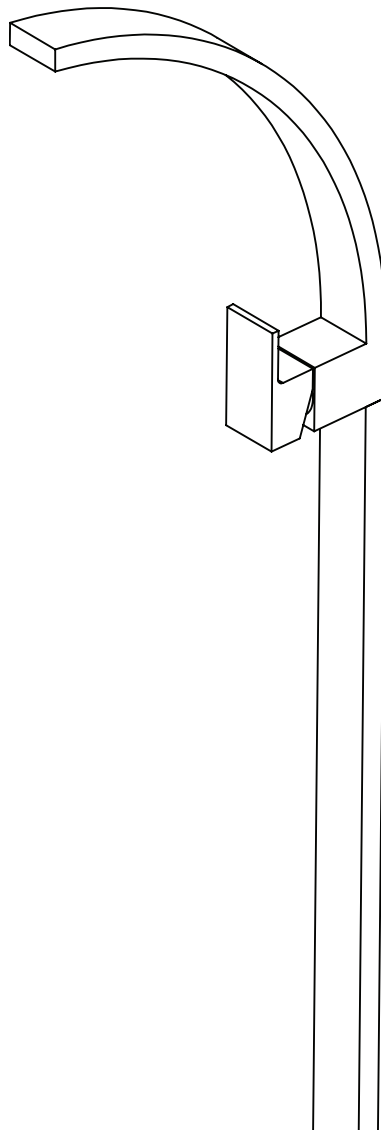

P A R
TAPS



www.partaps.com



[/ParTapsPtyLtd](https://www.facebook.com/ParTapsPtyLtd)



[@par_taps](https://www.instagram.com/par_taps)

Installation Instructions

Burj Bath Filler Mixer

Main Components

- | | | | |
|----------|---------------------------------------|----------|---------------------|
| 1 | Mixer Body Sleeve with Mounting Plate | 4 | Mounting Base |
| 2 | Neck with Mixer Handle & Cartridge | 5 | Right-Angle Elbows |
| 3 | Water Feed Tubes | 6 | Braided Water Hoses |
| | | 7 | Base Cover |

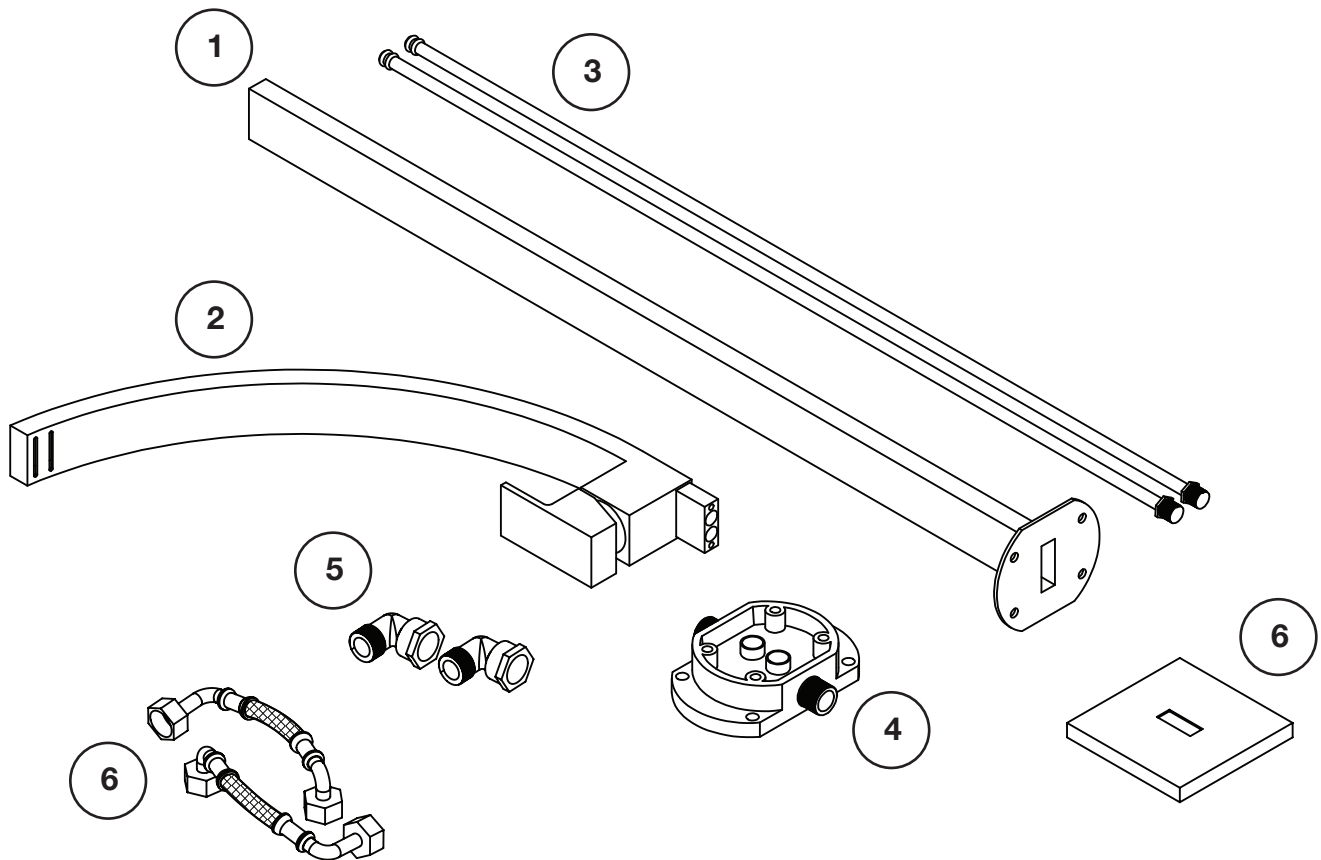

Also supplied:



Grub Screws (4)

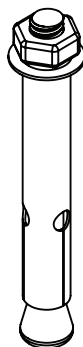

Dynabolts (4)



Small Mounting Bolts & Spring Washers (4)

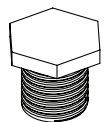

Test Caps (2)

01

Before commencing installation, disassemble the Bath Filler Mixer as shown.

Remove the water feed tubes from the base and replace them with the threaded testing caps.

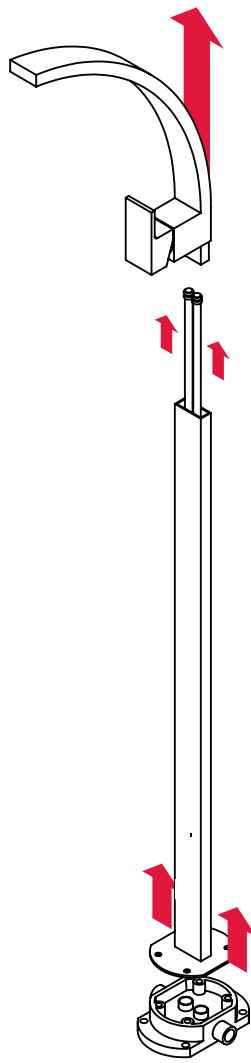

Fig A. Disassembly of components

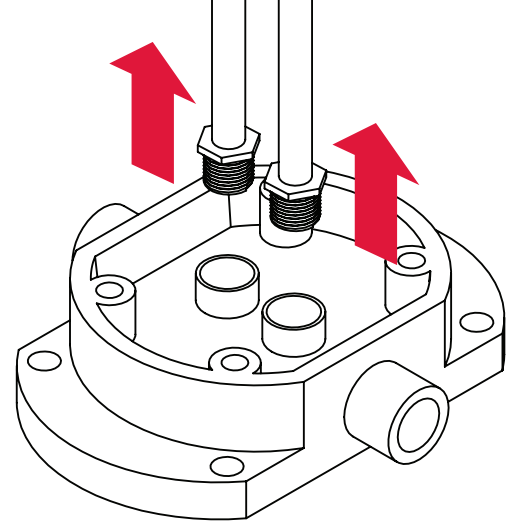

Fig B. Removing water feed tubes from base

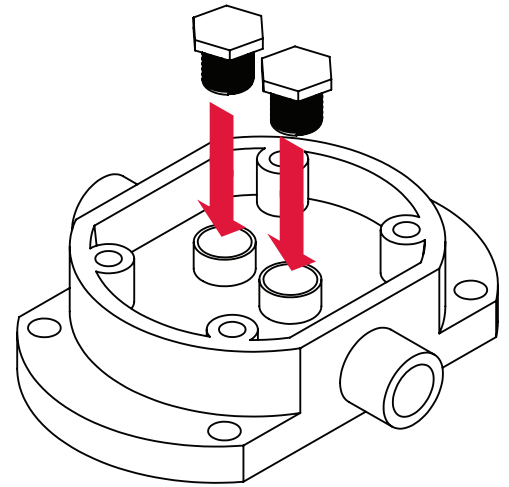
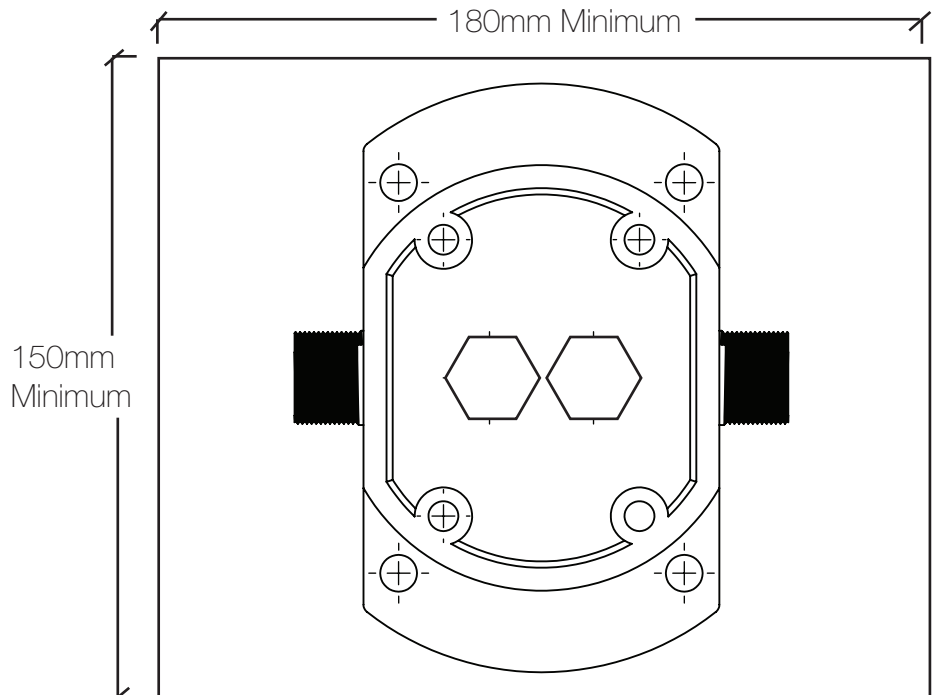
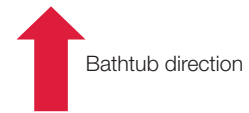

Fig C. Inserting caps into base

02

Place the base in the desired location on the floor, ensuring that a curved face of the base faces the bathtub.

Ensuring the base does not move, mark the outline of the floor pit around the base. The floor pit must measure at least 180mm x 150mm as shown, which provides 10mm space around all components once installed. The pit may be larger if preferred.



03

When you are satisfied with the location of the base, cut out the floor pit. The pit must be at least 35mm deep to ensure that the base remains under the floor.

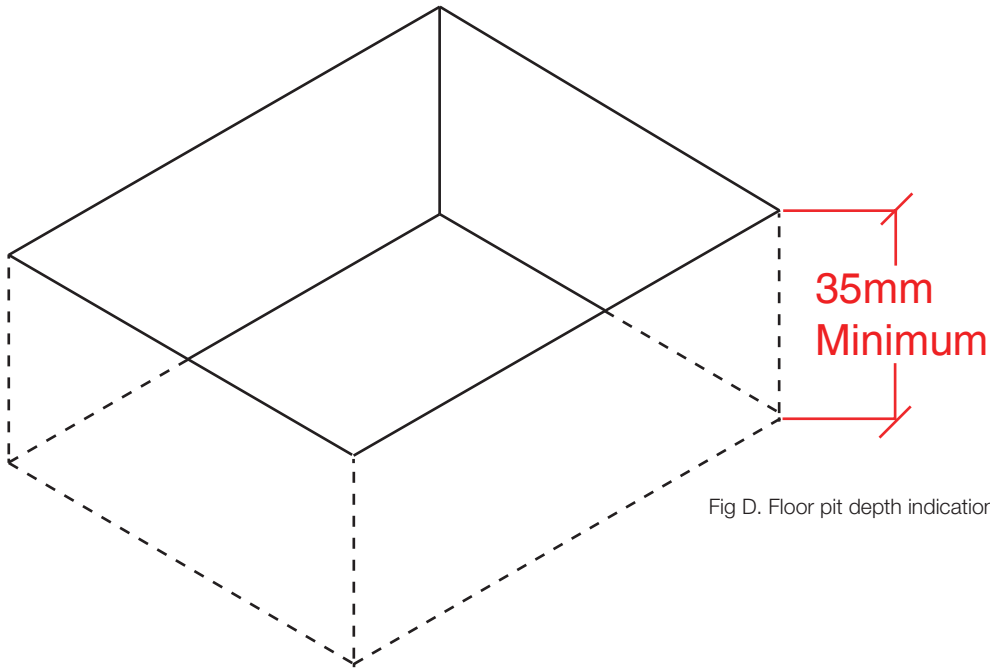

Fig D. Floor pit depth indication

Please note that the depth of the floor pit will dictate the overall height of the Bath Filler once installed. The bottom plate of the Bath Filler body may sit on or underneath the tiled floor surface, but the base must remain underneath.

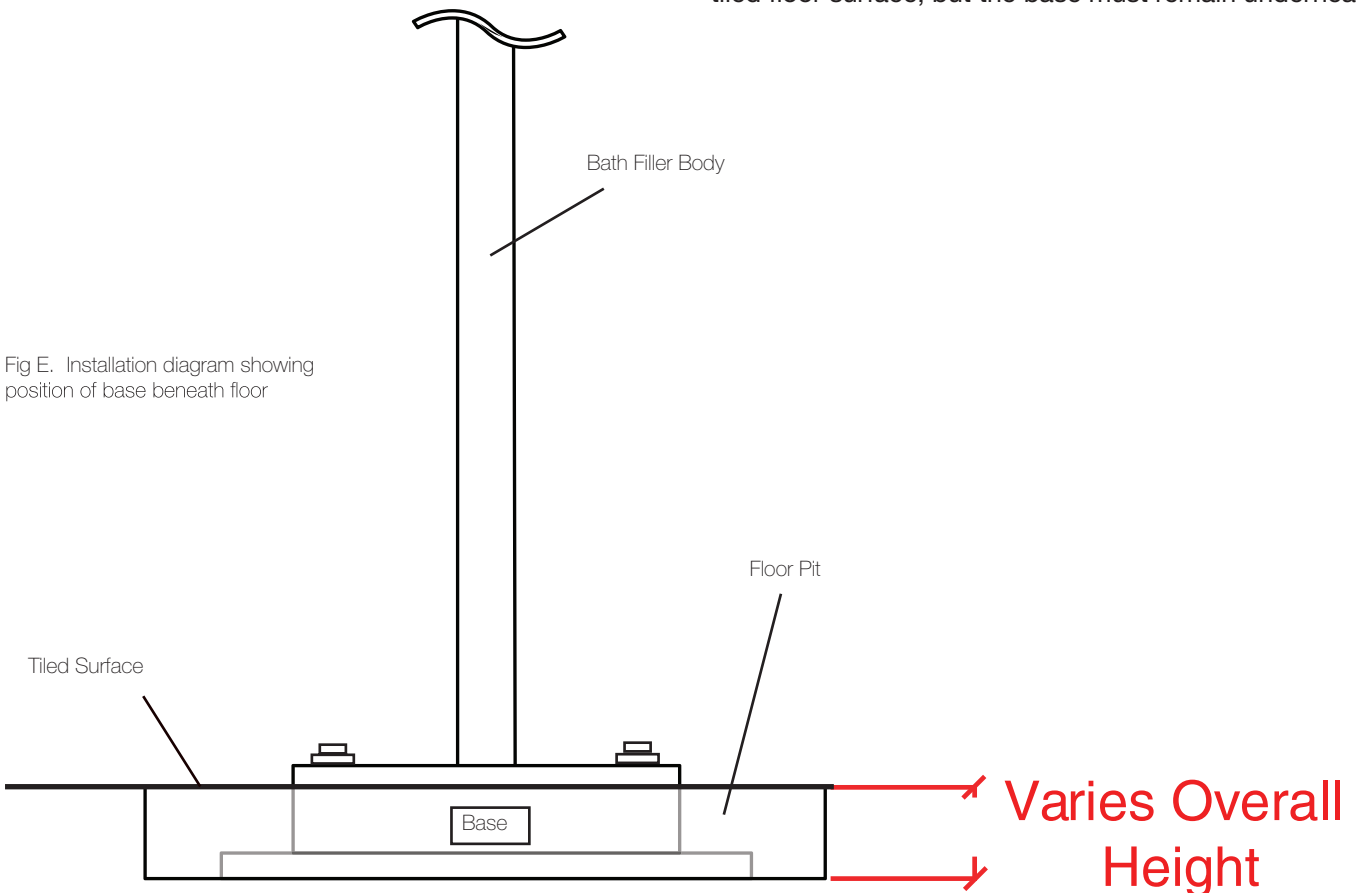

Fig E. Installation diagram showing position of base beneath floor

04

Screw the elbows onto the base as shown, ensuring that a tight fit is used and that they are facing in opposite directions. When standing facing the bathtub, the left elbow should point towards the tub, and the right elbow, away from it. The elbows may be slightly angled upwards once screwed on.

IMPORTANT: Teflon tape must be applied to the base threads before connecting elbows to ensure water-tight seal.

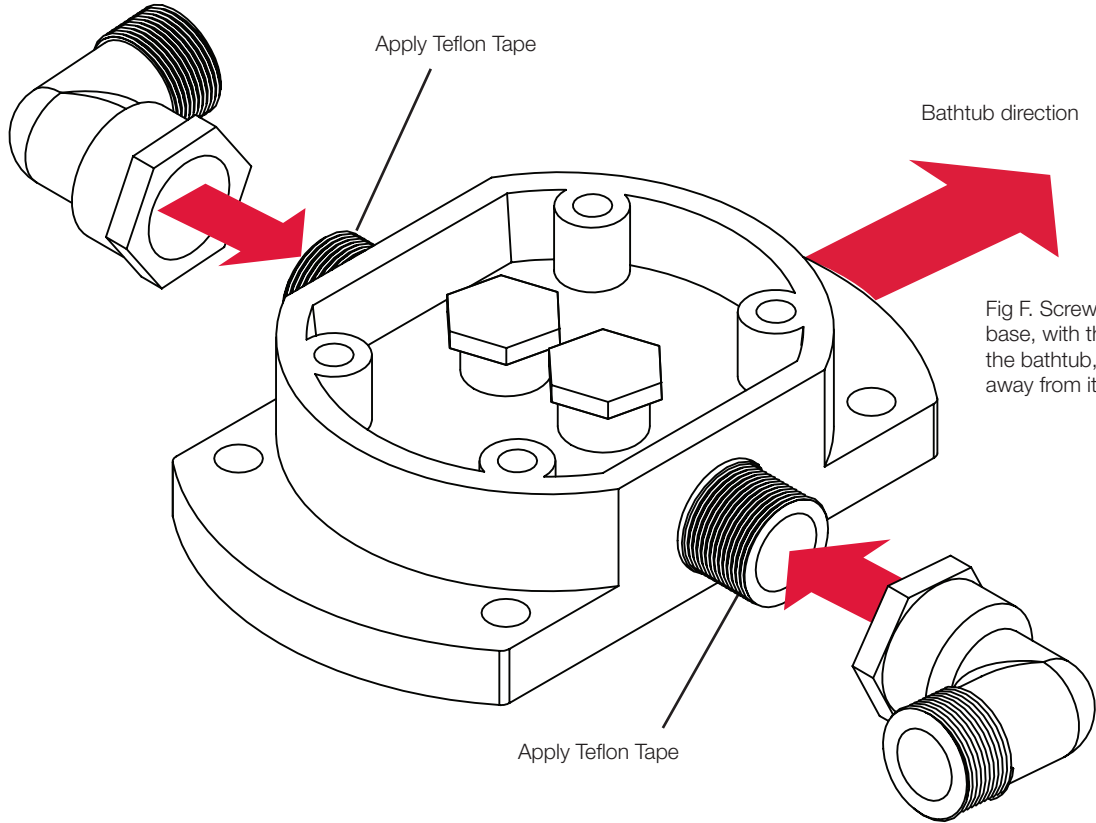

Fig F. Screwing elbows onto base, with the left elbow facing the bathtub, and the right elbow away from it.

05

The mains water lines need to be installed either side of the base, behind each elbow with a 1/2-inch female thread protruding from the floor. The water lines require at least 10mm of thread to connect properly.

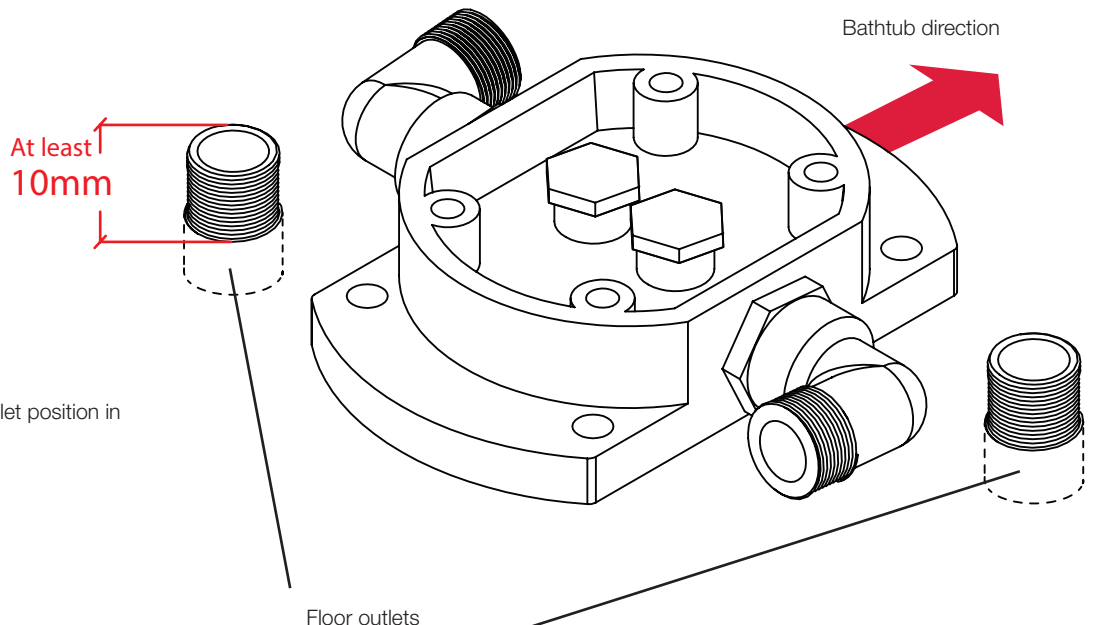

Fig. G. Floor outlet position in relation to base.

06

The mains outlets must be installed at 80mm either side of the base as shown.

Please measure accurately. No more than $\pm 2\text{mm}$ may be allowed when installing these parts.

Fig. H. Floor outlet positioning dimensions. Must be followed.

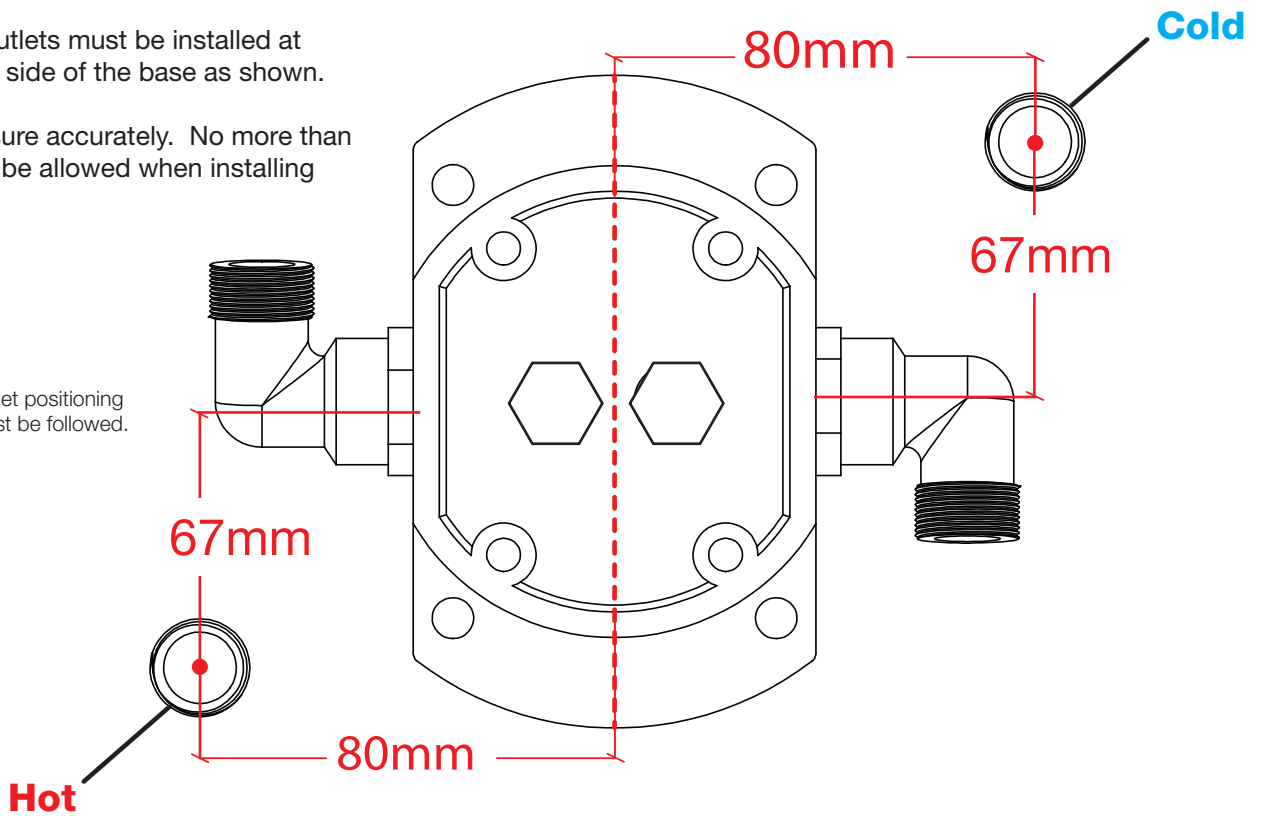

07

Ensuring the base is facing the correct direction, place it into the floor pit and fix to the floor with the four Dynabolts supplied.

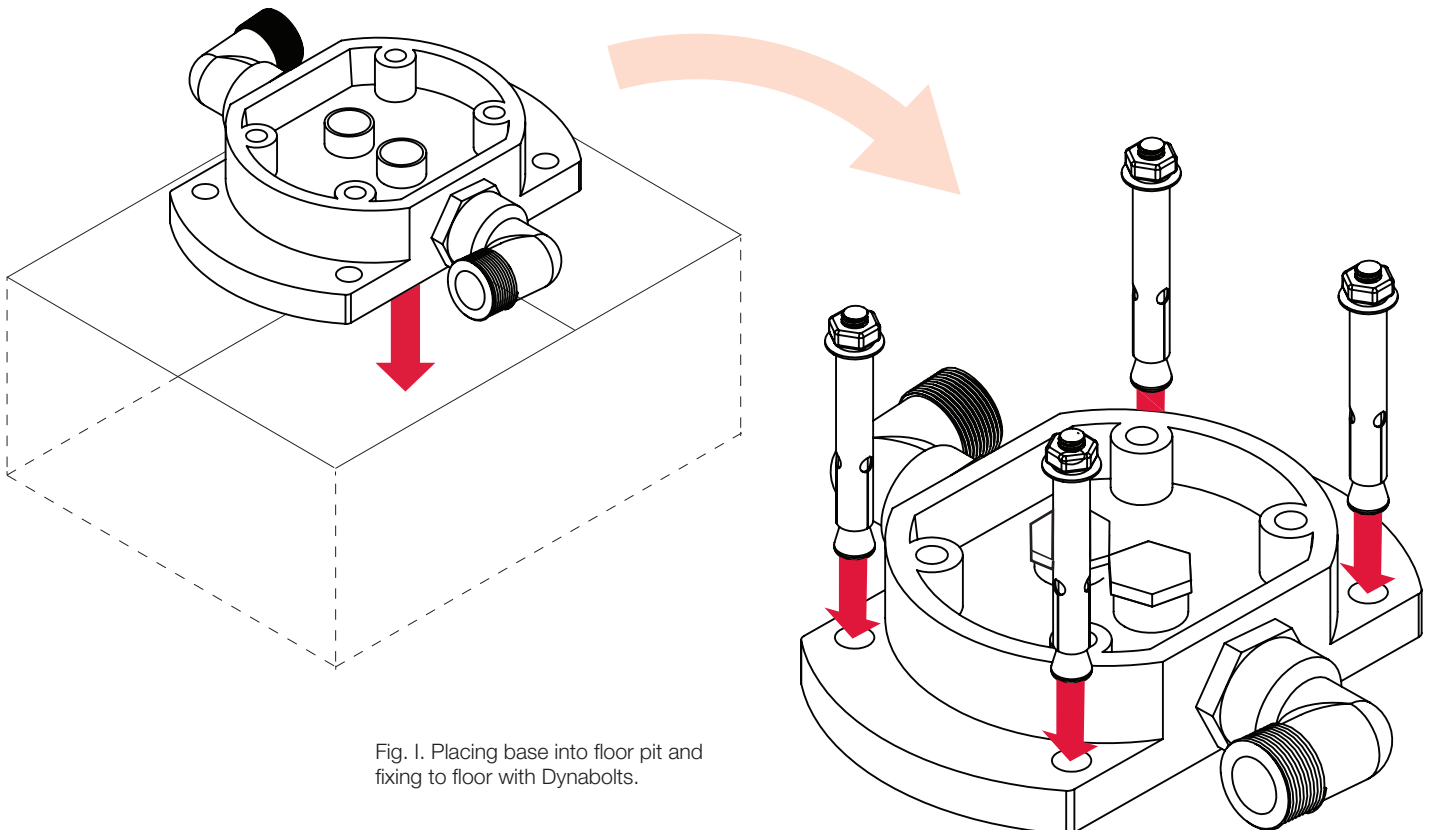

Fig. I. Placing base into floor pit and fixing to floor with Dynabolts.

08

Screw the braided water lines onto the elbows, ensuring that the blue rubber cone fits evenly into the elbow opening. Some thread on the elbow may remain exposed once tightened.

The elbows may need to be rotated during this procedure.

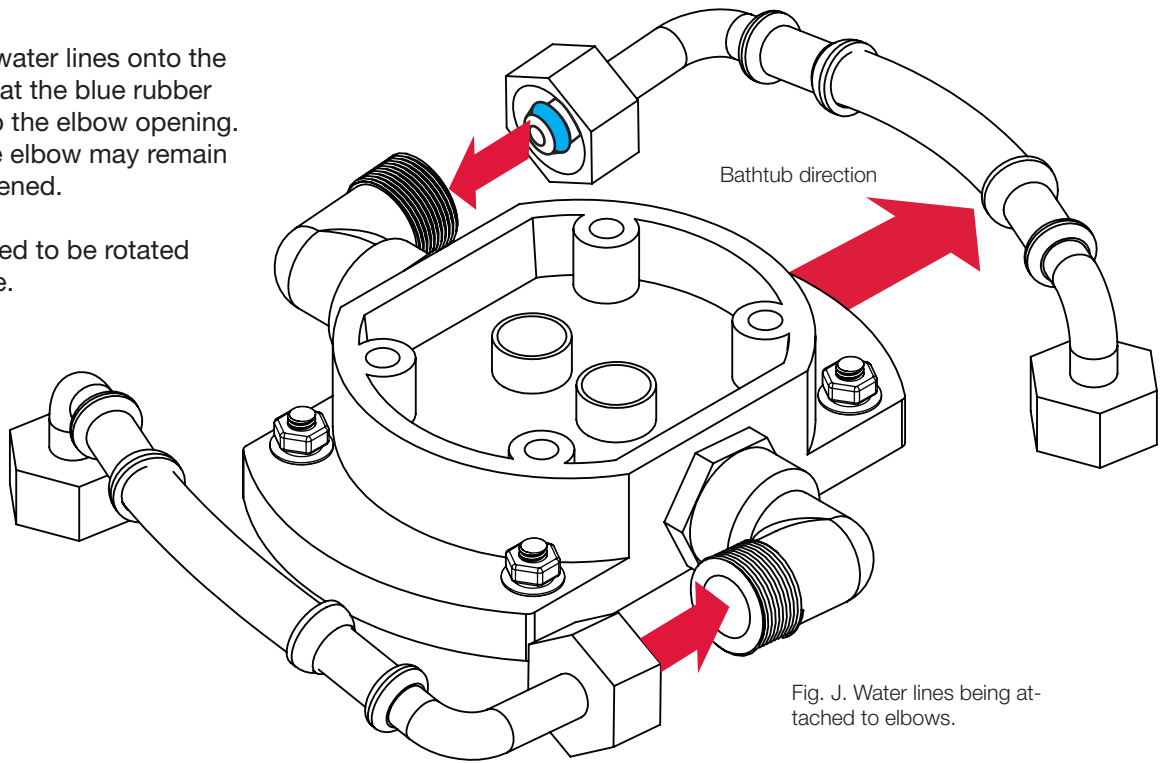

Fig. J. Water lines being attached to elbows.

09

Connect the base water lines to the floor outlets, ensuring that the hot and cold lines are running to the correct sides of the base (see opposite page). Tighten the nuts securely, but do not overtighten.

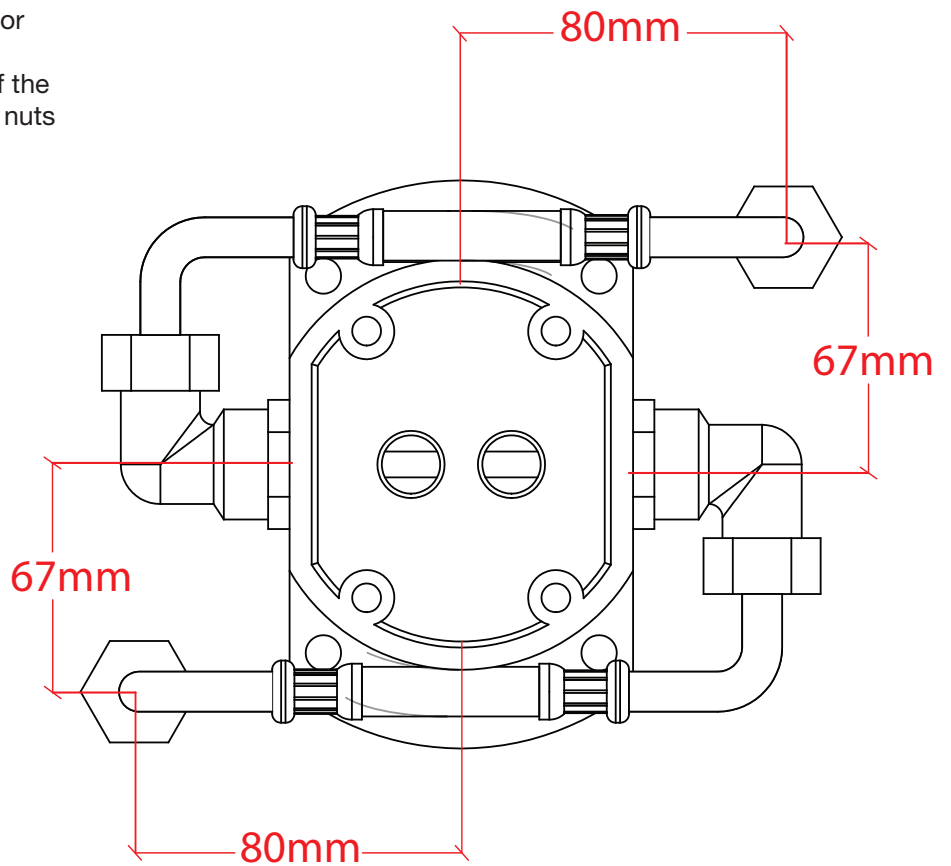

Fig. K. Water lines flexing to allow small shift of floor outlet location.

10

Double-check the water lines are running to the correct sides of the base. When standing behind the base facing the bathtub, the picture below shows the correct layout of the water lines and base outlets.



Bathtub direction

Fig. L. Layout of hot and cold water lines.

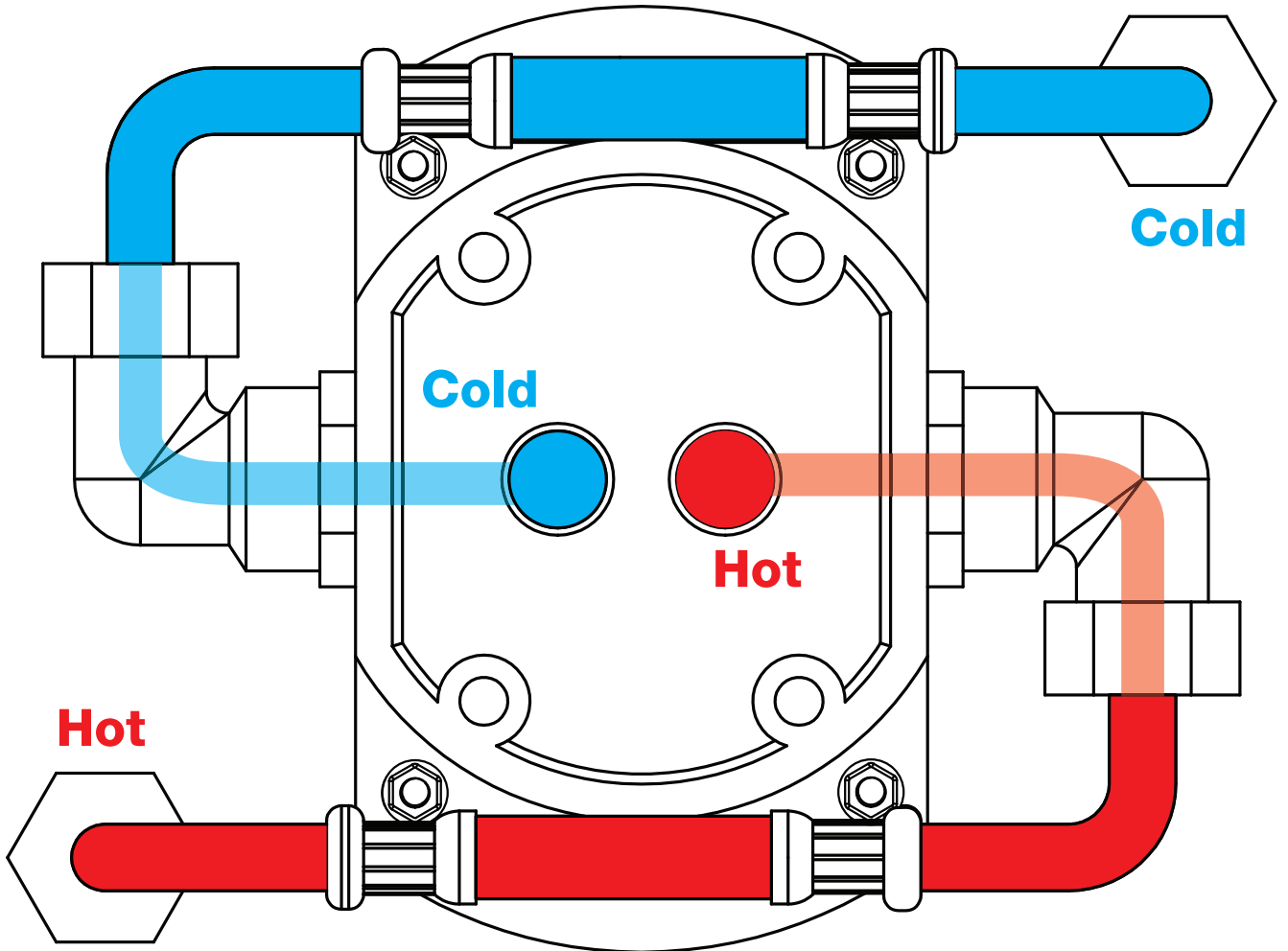

11

With the testing caps still in place, turn on the mains water supply and test the connections for leaks. If any leaks are present, turn off mains water and check the seals on each of the hose connections.

Turn off mains water and remove the testing caps when finished.

12

After removing the testing caps, apply lubricant to the threaded ends of the water feed lines, ensuring the rubber O-rings are attached. Screw the water lines into the base and tighten with a spanner until they are secure.

Fig. M. Water feed tubes being connected to base.

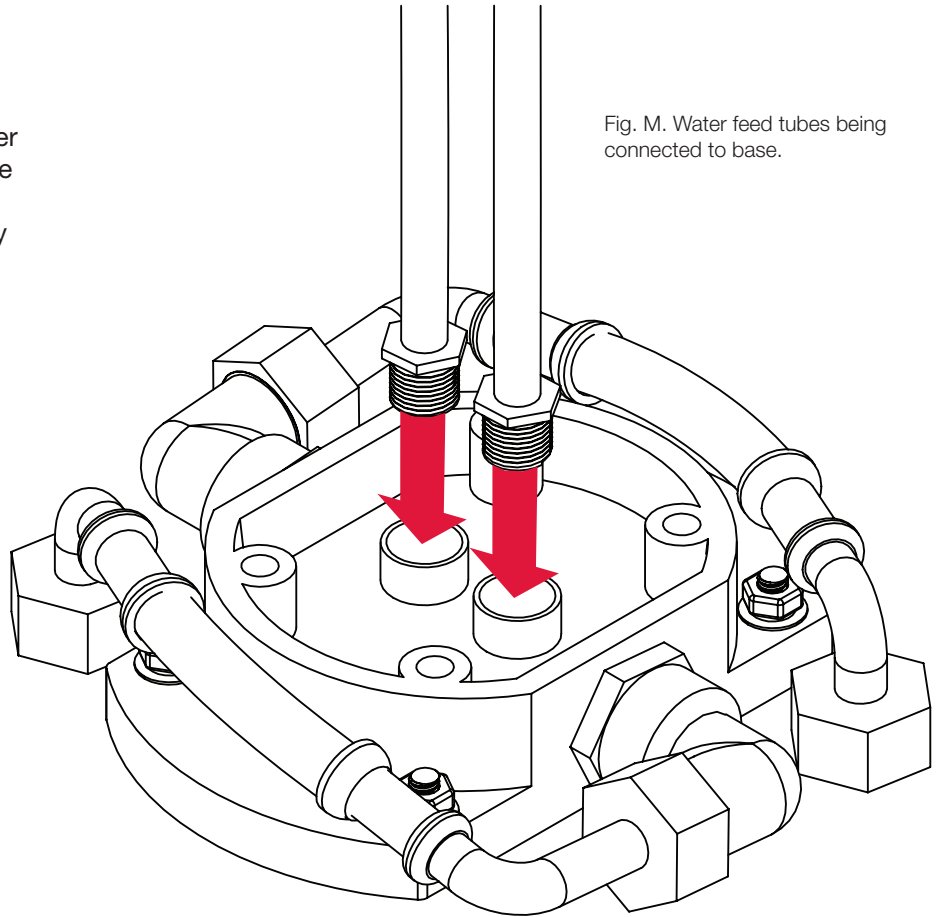

13

With the water lines installed, lift the body of the Bath Filler Mixer over the tubes and place it on the top of the base.

Use the 4 screws with spring washers supplied to fix the body down to the base.

IMPORTANT:

While the base is depicted here for clarity, no part of the base or the water hoses should be above the floor.

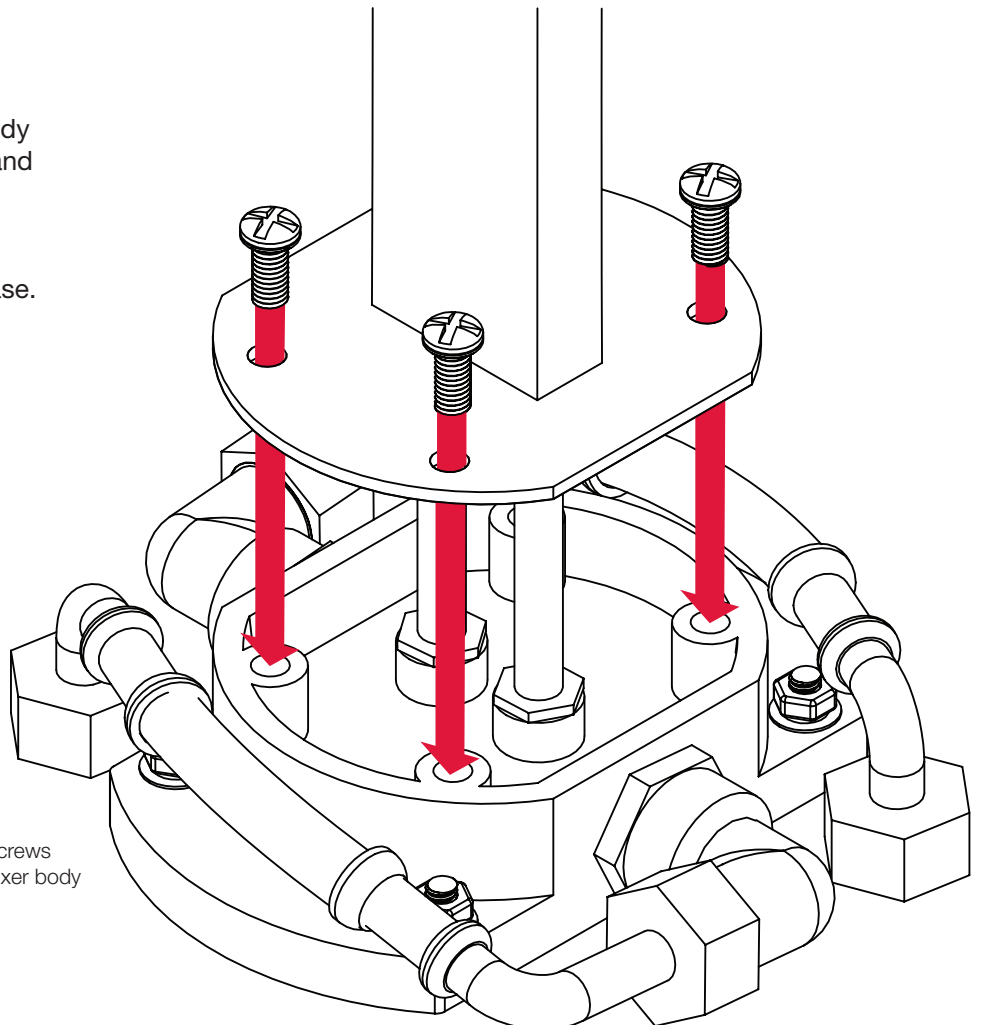

Fig. N. Base mounting screws connecting Bath Filler Mixer body to base.

14

Fit the floor base cover over the Bath Filler Mixer Body, and lower to the floor's tiled surface.

The base cover does not need to be fixed to anything.

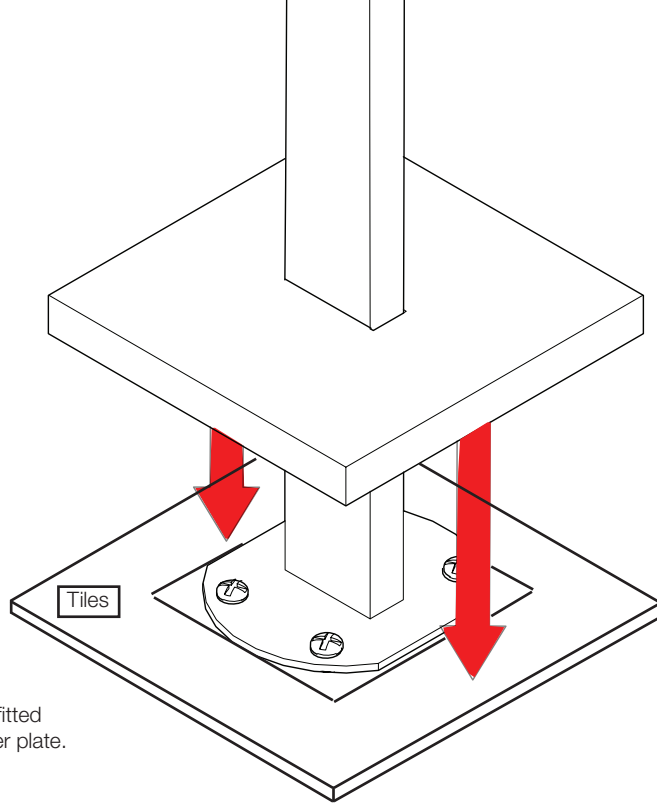

Fig. O. Base cover being fitted over Bath Filler Mixer lower plate.

15

Locate and apply lubricant to the rubber O-rings on the tops of the water feed lines protruding from the Bath Filler Mixer body, and fit the neck and mixer assembly into the body as shown.

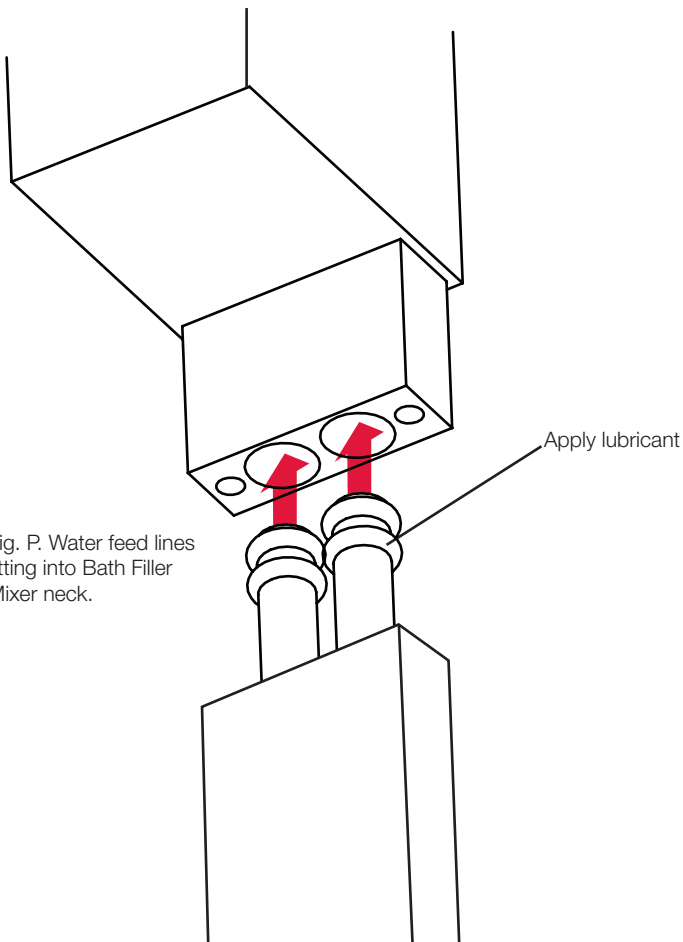

Fig. P. Water feed lines fitting into Bath Filler Mixer neck.

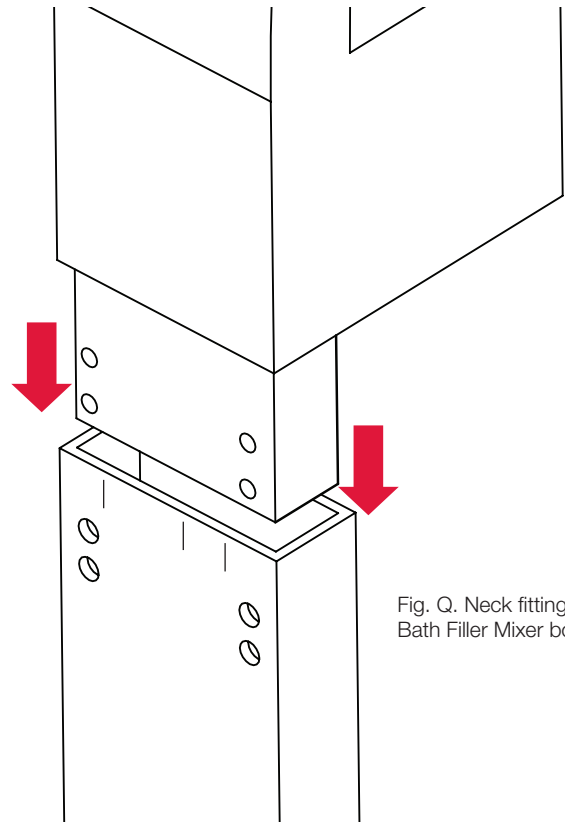

Fig. Q. Neck fitting into Bath Filler Mixer body.

16

Fix the neck into the body through the four rear holes with the 4 grub screws supplied. Avoid over-tightening these screws as they may cross-thread.

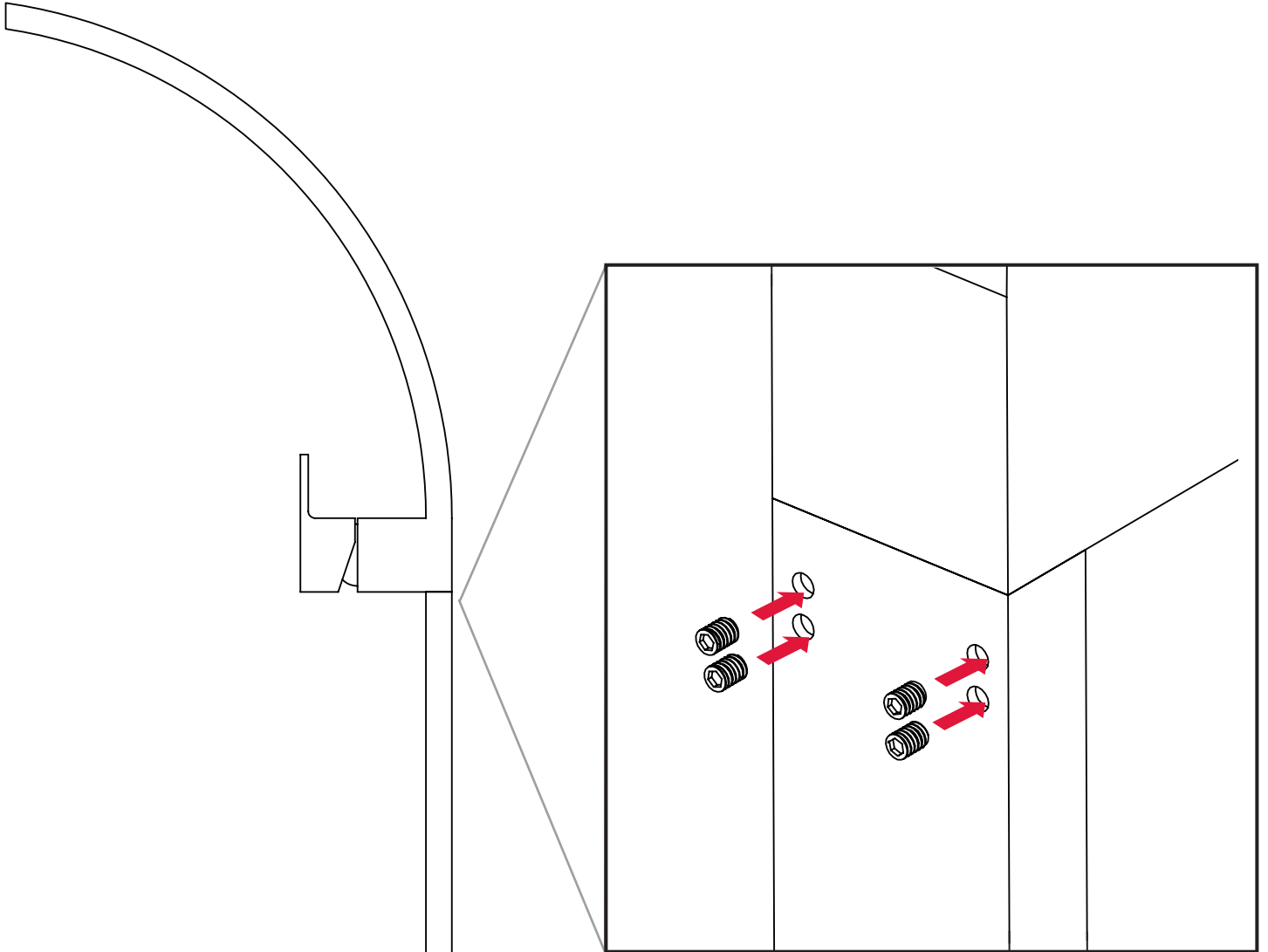

Fig. R. Grub screws fitting into rear of Bath Filler Mixer neck.

Installation Complete!

Your Burj Bath Filler Mixer is now ready to be used.

