

Bottle Trap

Installation Guide

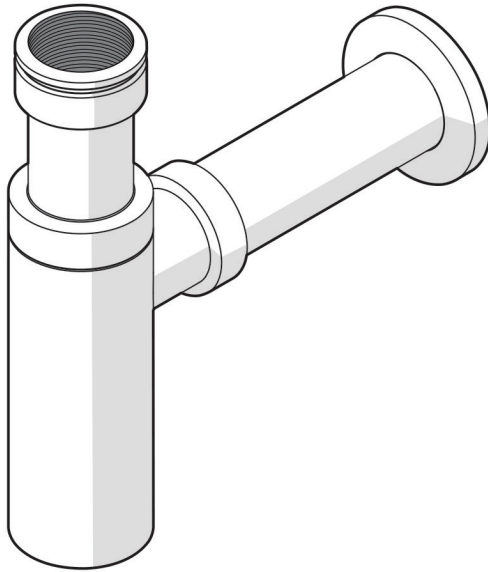

P A R
TAPS



www.partaps.com



[/ParTapsPtyLtd](https://www.facebook.com/ParTapsPtyLtd)



[@par_taps](https://www.instagram.com/par_taps)

Important Information



Prior to Installation:

- Please read these instructions completely before installing.
- All instructions serve as a guide only and must be installed by a licensed plumber in accordance with AS/NZS 3500.1.
- Installation carried out by unlicensed individuals will void all warranties.
- Ensure water supply lines are closed.
- Supply lines must be flushed prior to installation to remove any foreign matter.
- All products are suitable for use with most instantaneous hot water heaters, however are not compatible with gravity-fed water systems.

Note: Only to be used in conjunction with 32mm Waste. Must use part (1)

Main Components for F99.031

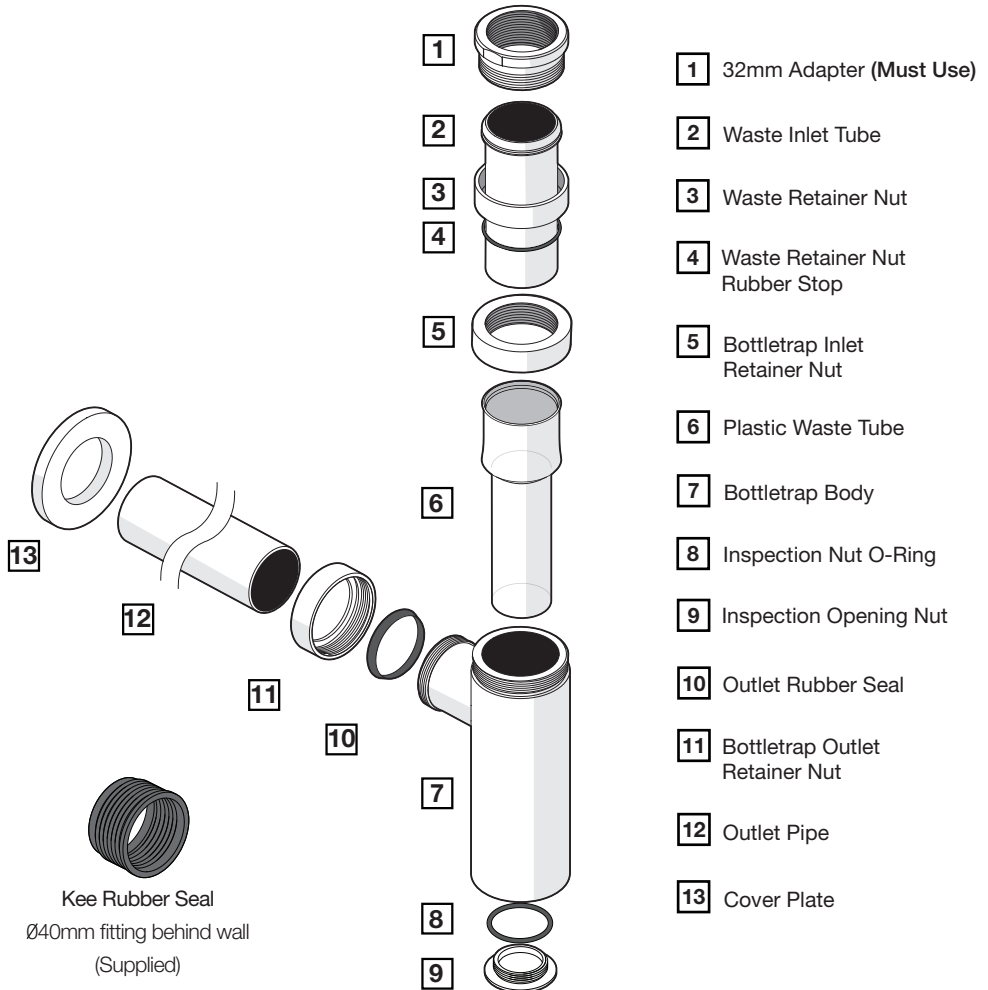

IMPORTANT: Please Ensure there is a minimum 1.5 degree fall in the Outlet Pipe when installed to allow waste water to flow smoothly.

1. To calculate the length of the Outlet Pipe (12), fit the pre-assembles bottletrap to the basin and measure from the bottletrap shoulder (A) to elbow coupling (B). Add 25mm for internal pipe connection. (Fig A).

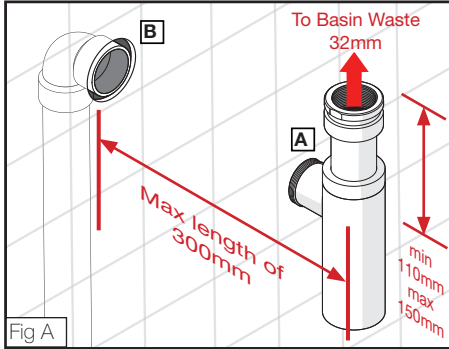

2. Cut the the Outlet Pipe (12) to the calculated length removing all swarf material from the end of the pipe. (Fig B)

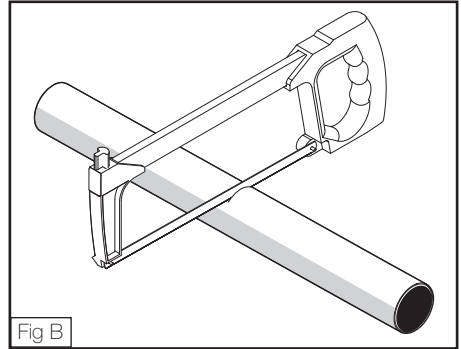

3. Once the Bottletrap is removed from the basin and seals lubricated, slide the Outlet Pipe (12) into the Bottletrap shoulder and tighten with the Outlet Retaining Nut (11). (Fig C)

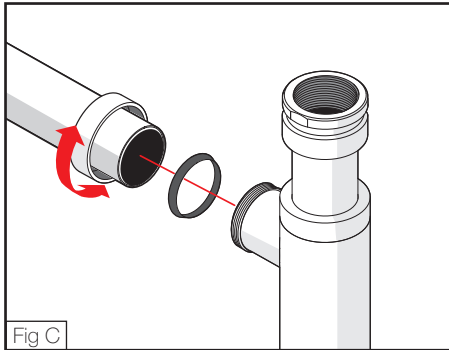

4. Slide the Cover Plate (13) and Kee Rubber Seal onto the Outlet Pipe (12). (Fig D)

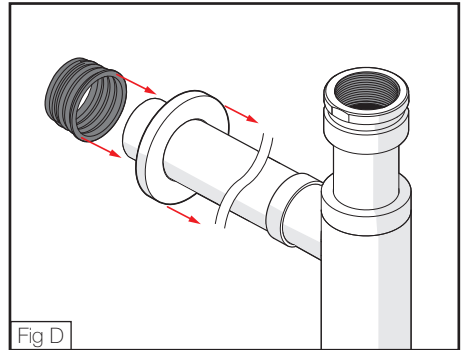

5. Lubricate the Kee seal and push-fit the Bottletrap and Outlet Pipe assembly into the elbow coupling. (Fig E)

Fit the Bottletrap to the basin waste ensuring the height is adjusted to allow fall of water.

Test to ensure the fittings are secure and the Bottletrap is water tight.

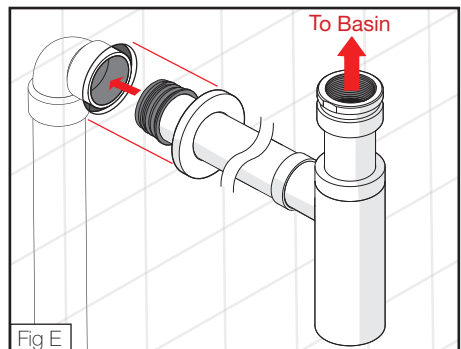



P A R
TAPS