

Button Decal Replacement

Installation Guide

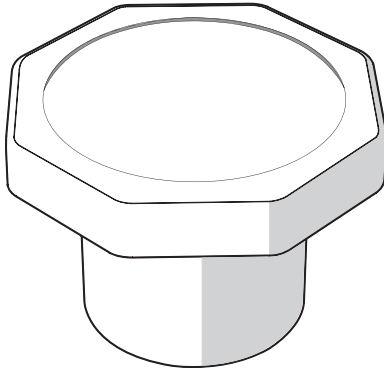

P A R
TAPS



www.partaps.com



[/ParTapsPtyLtd](https://www.facebook.com/ParTapsPtyLtd)



[@par_taps](https://www.instagram.com/par_taps)

Important Information



Prior to Installation:

- Please follow the instructions to replace the “hot” and “cold” decal on your button.
- Avoid wetting your decal for the first 24 hours

1. Firstly remove the old decal from the button.

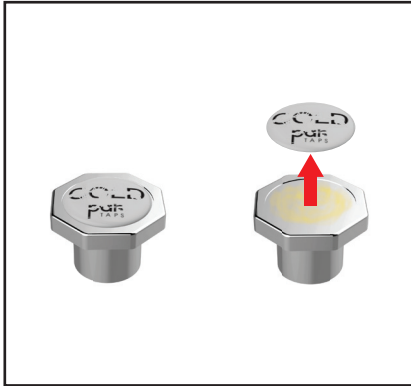

2. Clean the surface area with Methelated Spirits and allow 5 mins to dry.



3. Carefully remove decal off backing sheet. Apply the decal to the button and hold there for approx. 1 min with firm pressure.

