

Ceramic Discs

Installation Guide

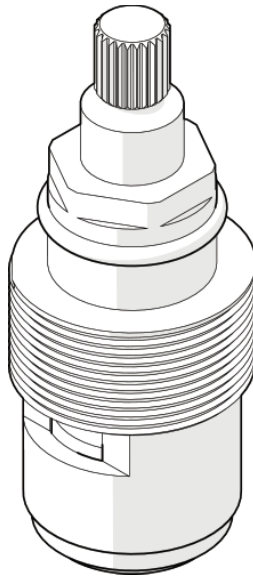

P A R
TAPS



www.partaps.com



[/ParTapsPtyLtd](https://www.facebook.com/ParTapsPtyLtd)



[@par_taps](https://www.instagram.com/par_taps)



Important Information

Prior to Installation:

- Please read these instructions completely.
- All instructions serve as a guide only and must be installed by a licensed plumber in accordance with AS/NZS 3500.1. Installation carried out by unlicensed individuals will void all warranties.
- Ensure water supply lines are closed.
- Supply lines must be flushed prior to installation to remove any foreign matter.
- All products are suitable for use with most instantaneous hot water heaters, however are not compatible with gravity-fed water systems.

Water Pressure & Temperature:

This Par Taps products are to be installed by a Licensed Plumber in accordance with AS/NZS 3500.1

Maximum Water Temperature — — — — — 80° Celcius

Maximum Water Pressure — — — — — 1600kPa

Regulatory Maximum Water Pressure — — — — — 500kPa

Note: In areas where the recommended maximum water pressure is exceeded, pressure-limiting valves must be installed by a licensed plumber.

(A) Wall Installation

(B) Hob Installation

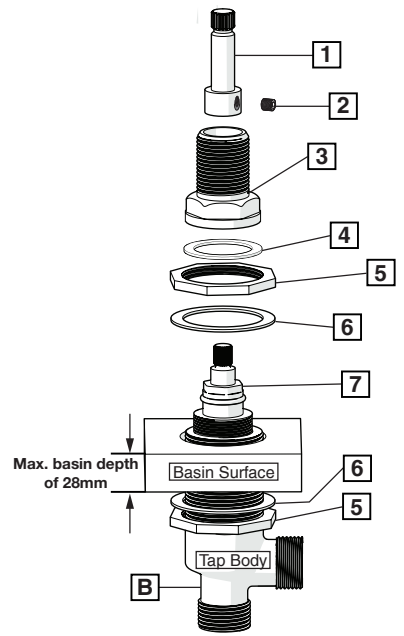
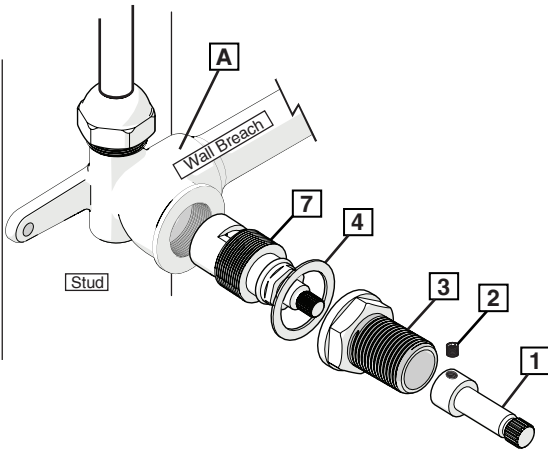

- | | |
|----------------------------|---------------------------------|
| 1 Extensions | 5 Bench Locknut |
| 2 Grub Screw | 6 Plain Nylon Washer |
| 3 Cartridge Locknut | 7 Ceramic Disc Cartridge |
| 4 Red Fiber Washer | |

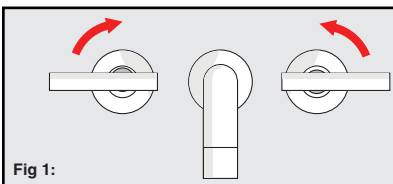

Fig 1:

Safety Note:

For your safety, Par Taps spindles are 'Contra Turn' designed. Handles should be fitted to turn/open towards the outlet thus preventing potential accidents such as scolding.

***NOTE: All Hob sets come complete and may only require handle alignment**

Tools Required • 2mm Allen Key • 14mm Deep Tube Socket • 25mm Deep Socket
24mm Deep Socket (30mm Locking Nut Only)

1. Prior to installing ceramic disc assembly make sure seat surface is clean and smooth otherwise reseal and recheck. Also ensure that lines have been flushed.
2. Remove cartridge lock nut (3) from the Ceramic Disc Assembly (Fig.7A) as supplied. Ensure that the hot and cold indicators located on the bottom of the Ceramic Disc Assembly (Fig.7A) are placed in the corresponding side of the breach

Note: Please refer to Fig 1 for rotation of Par Taps Ceramic Disc Assemblies.

3. Insert ceramic disc assembly (Fig.7A) into (A) wall breach or (B) tap body. Tighten ceramic disc assembly (Fig.7A) firmly using a 14mm Deep tube socket (not supplied).

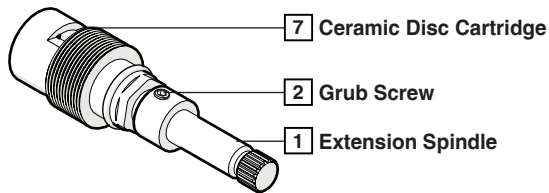

Fig 7A: Ceramic Disc Assembly

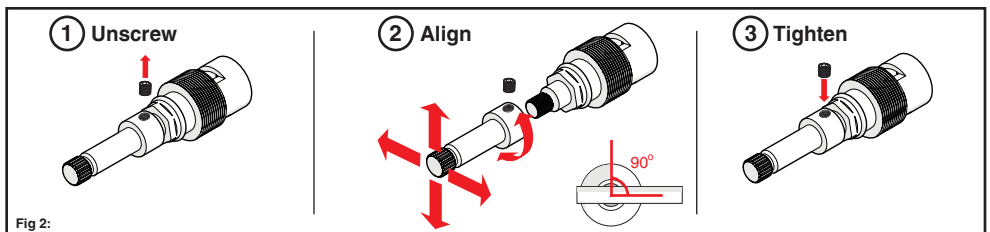

Fig 2:

4. Ensure that the disc is in the closed position and then fit handle to align.
***Fig 2: To align the handle, loosen grub screw/s (2) from the extension (1) using 2mm allen key, then rotate the position of the extension (1) and ceramic disc cartridge (7) until the desired handle position is achieved.**
5. Once aligned ensure the extension (1) is pushed firmly on to the ceramic disc (7) and tighten grub screw/s (2) firmly using the 2 mm allen key. Take care whilst doing this.
6. Place the fibre washer (4) over the ceramic disc assembly (7A) and onto the face or the (A) wall breach or (B) basin body.
7. Tighten the locking nut (3) over the ceramic disc assembly (7A) and tighten firmly using a 25mm deep tube socket. *For some product ranges such as Tudor hob, please use 24mm socket
8. Turn water supply on and check for leaks, then complete tapware assembly.



P A R
TAPS