

High Rise Dual Shower with Divertor

Installation Guide

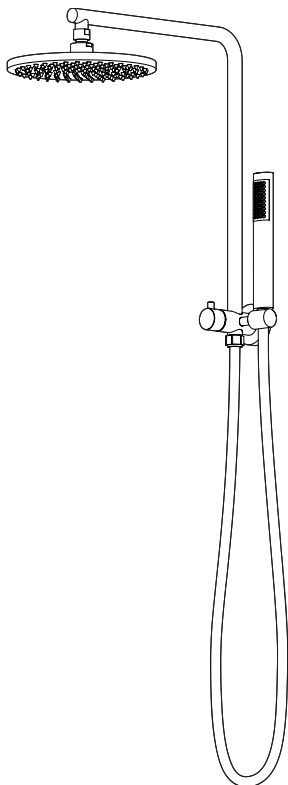

P A R
TAPS



www.partaps.com



[/ParTapsPtyLtd](https://www.facebook.com/ParTapsPtyLtd)



[@par_taps](https://www.instagram.com/par_taps)

Installation

1. Using a spanner, screw the Push-fit connector to the 1/2 thread.

2. Push-fit the Divertor Body (3) onto the connection and tighten both grub screws on top and below the body.

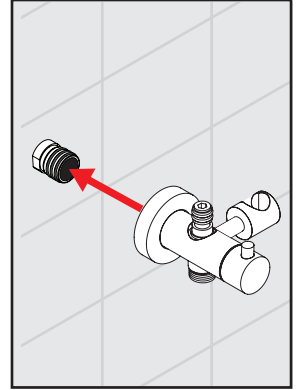
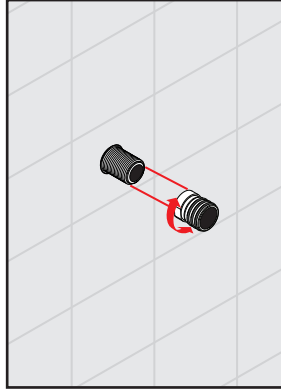
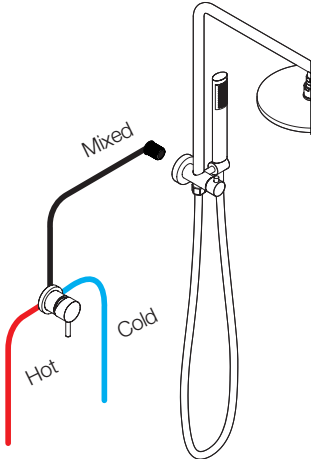

3. Push fit the Shower Arm (1) onto the nipple of the Divertor Body (3). Tighten the grub screw to secure the arm to the nipple.

4. Screw the Shower Rose (2) to the Arm (1) and tighten with a spanner.

5. Attach the Hose (5) to the Handpiece (4) and tighten to the base of the Divertor Body (3).

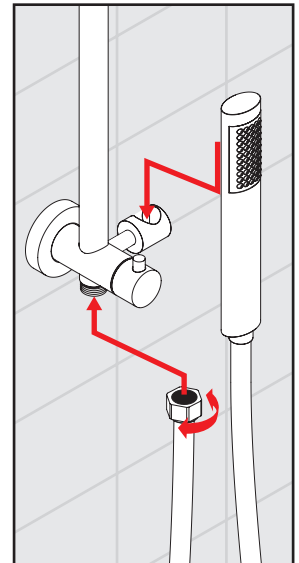
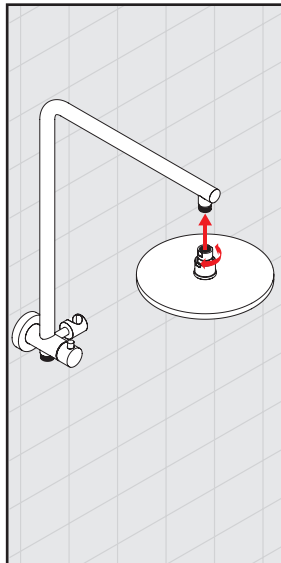
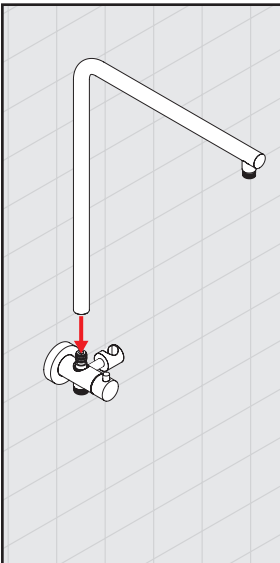



P A R
TAPS